

# LOCATION MAP

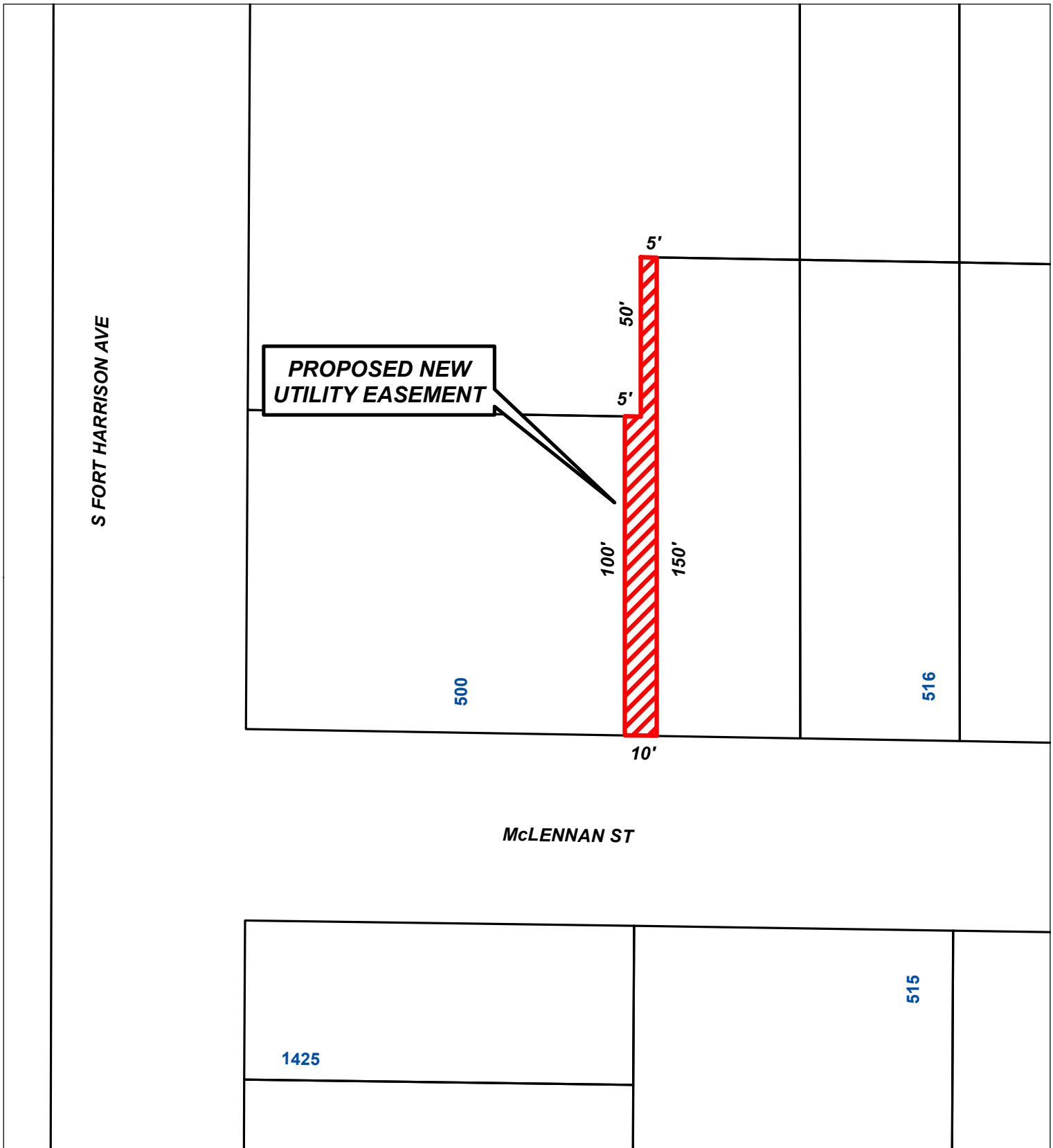

## Proposed Utility Easement 500 McLennan St.



Prepared by:  
Engineering Department  
Geographic Technology Division  
100 S. Myrtle Ave, Clearwater, FL 33756  
Ph: (727)562-4750, Fax: (727)526-4755  
www.MyClearwater.com

Map Gen By: **KN**

Reviewed By: **RB**

Date: **3/25/2021**

Page: 1 of 1

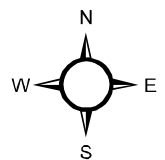

Scale: **N.T.S.**