

# Coachman park Redevelopment

1. RFP (WS 12-13)
2. VE Cost Summary
3. VE Plan
4. Next Steps



11-30-2020

**CLEARWATER**  
BRIGHT AND BEAUTIFUL • BAY TO BEACH

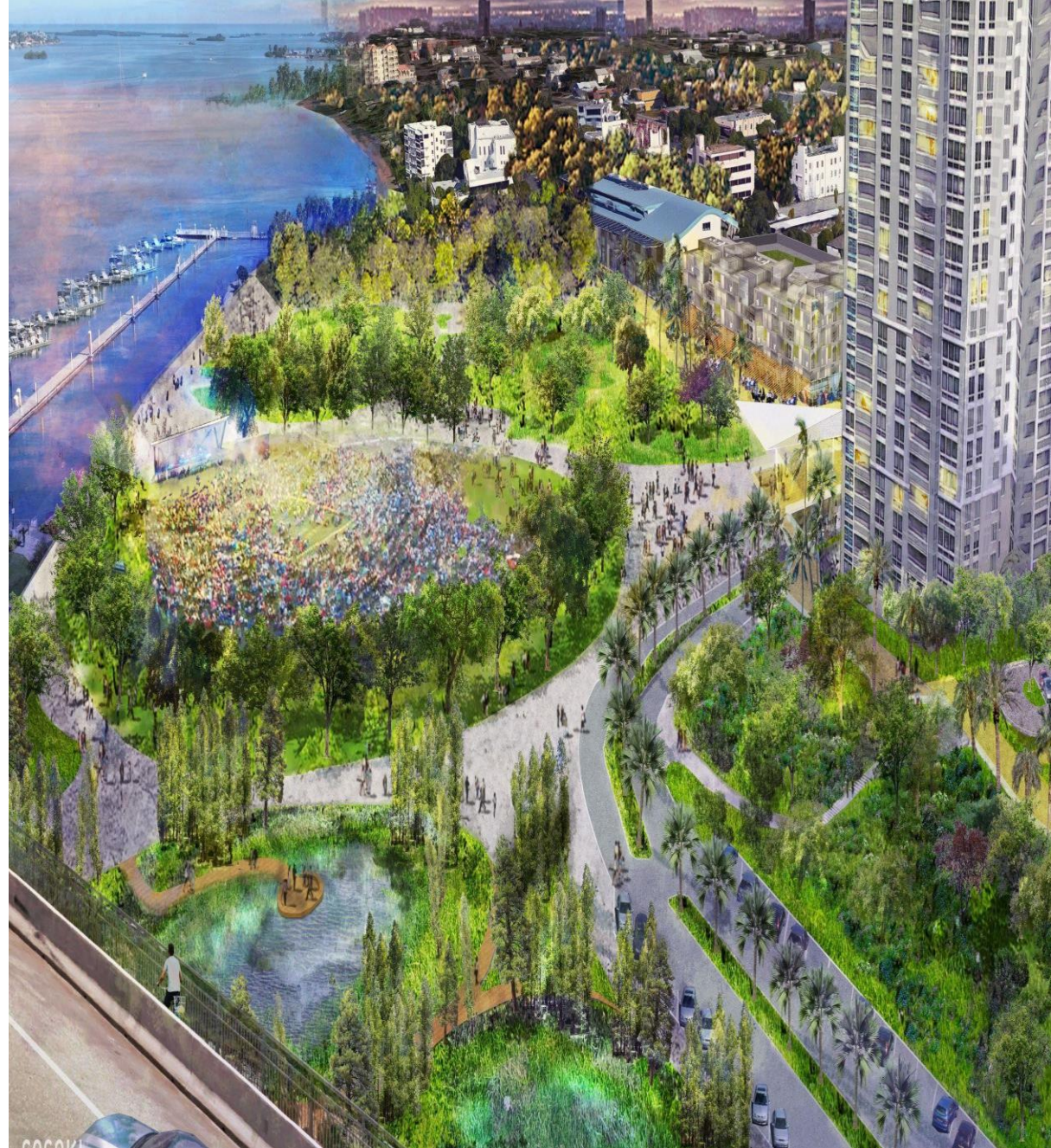

## RFP:

1. Draft RFP is under review. We anticipate a draft for CC Discussion on 12-13 work session.

# Value Engineered Process

1. Staff and Team members will summarize the value engineering process and spreadsheet and where we are to date.

# Financially Resourced Plan

1. Staff and Team will provide an overview of the funded plan final design.
2. Concept direction for band shell seating cover and shading structure theme

# Next Steps

1. Value Engineered Option Analysis
  - a. Internal Staff Review/Analysis
  - b. Council review and evaluation
  - c. Program Analysis of Staff and Council Priorities
  - d. Council discussion and direction regarding potential additions and funding options

We will want to conclude this process over the next 90 to 120 days if possible.

## 2. Conservancy/Friends Discussion

- a. Parks Director will lead consideration and discussion of the next steps for community support function for the expanded redeveloped waterfront.
- b. Additional park enhancements may be opportunity for financial support and sponsorships.



# Coachman park Redevelopment

End of Slides

11-30-2020



**CLEARWATER**  
BRIGHT AND BEAUTIFUL • BAY TO BEACH

