

# LOCATION MAP

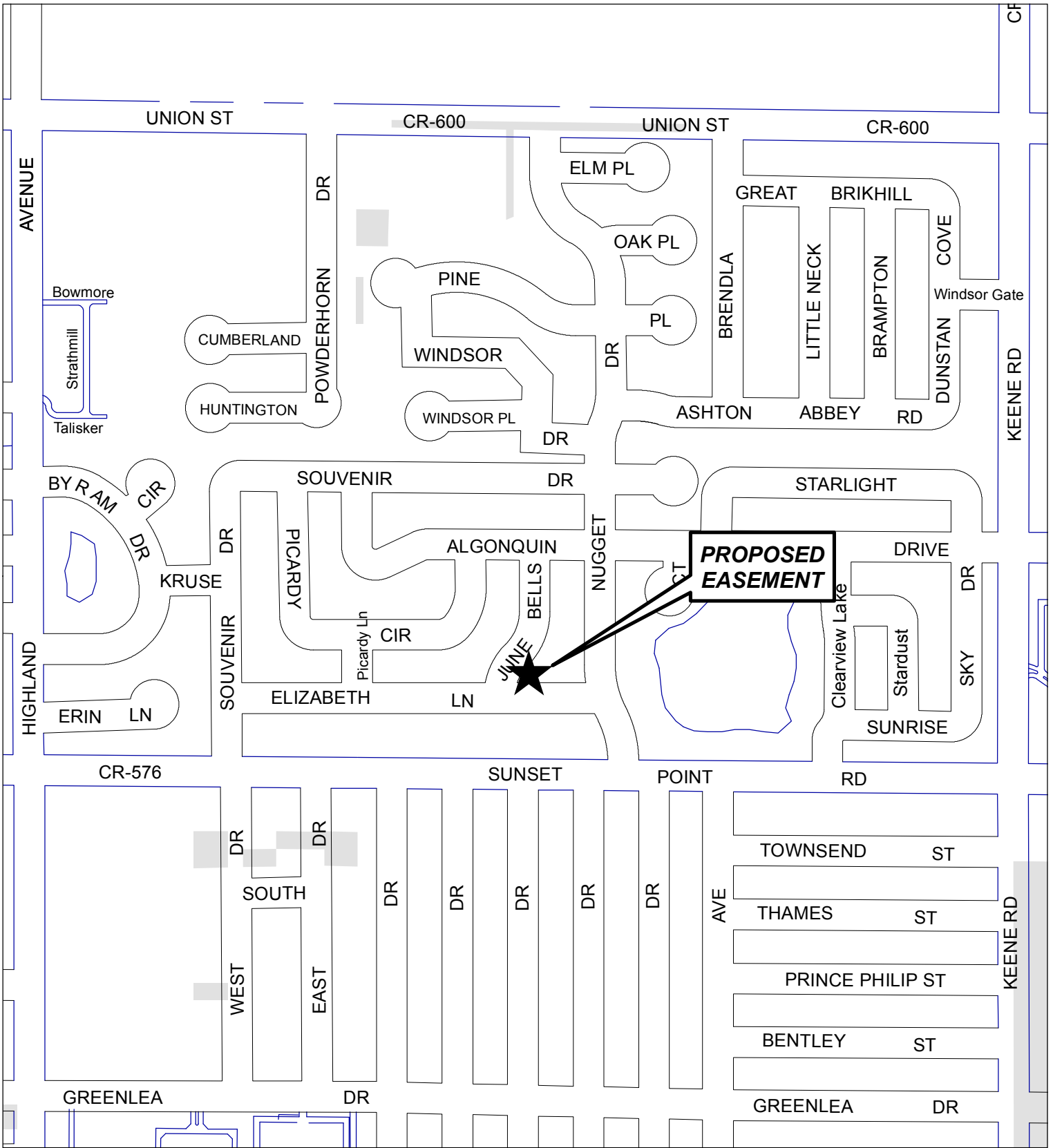

## PROPOSED EASEMENT TO CITY 1650 ELIZABETH LANE

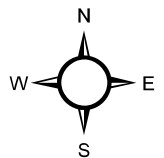

Scale: N.T.S.



Prepared by:  
Engineering Department  
Geographic Technology Division  
100 S. Myrtle Ave, Clearwater, FL 33756  
Ph: (727)562-4750, Fax: (727)526-4755  
www.MyClearwater.com

Map Gen By: **MBK**

Reviewed By: **JB**

Date: **3/17/2016**

Grid #: **252B**

S-T-R: **2-29n-15e**