

DICRO
DAVIS



CLEARWATER
BRIGHT AND BEAUTIFUL • BAY TO BEACH





ABOUT DICRO DAVIS

7x

National Art Commissions Awarded

2016

The Journey Begins

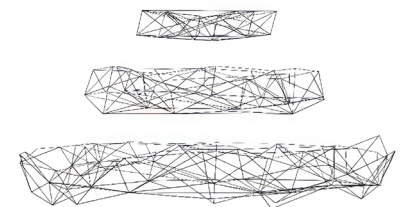
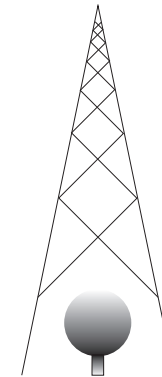
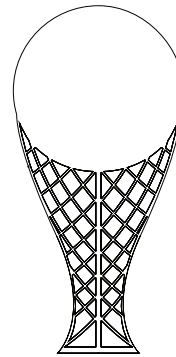
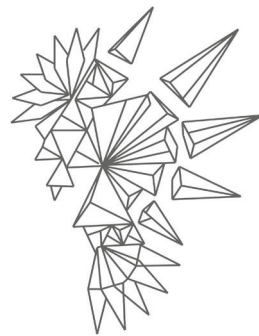
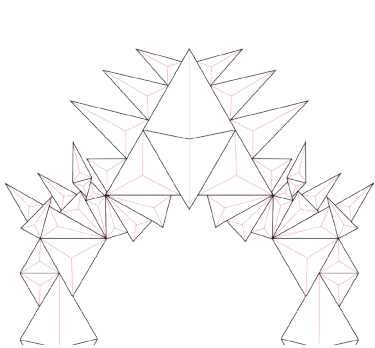

2016
Pulse Portal

2017
Emergence

2018
Quantum Mom
Quantum Dad

2019
iNSPIRE
Cognition
Elgin Express

2020
Evolve Lobby
Evolve Exec
Twice "More & More"



Investing in Iconic Art:

My Goal is to create a **visual landmark for Clearwater's New City Hall** that captures the rich heritage and exquisite natural surroundings. A Civic Beacon that can be enjoyed by generations.

My name is Davis McCarty. I am a full-time 3-D artist who builds polymorphic sculptures by using light-bending materials developed by NASA. That's the fancy way of saying it, anyway. I build them because I love seeing the smiles on adults' faces when they encounter my work for the first time, the disbelief, the double takes. I love seeing children run up to it, dancing in the shadows and inventing new games. I love when they run back for a friend and pull them at the wrist, pulling them into their new world, a world where anything is possible.

I invite you to take a journey with me, to rediscover the magic that lies within. Allow yourself to be drawn in by the enchanted color changing mirror rainbows, to experience the thrill of discovery, and to reconnect with the child within. For in doing so, you will find that the world once again becomes a place of infinite possibilities.

DAVIS

(815) 247-9638 | DM@DavisMcCarty.com | [@dicrodavis](https://www.instagram.com/dicrodavis)
200 Broad Ave. Los Angeles, CA, 90744 USA

DAVIS

CLEARWATER OCEAN

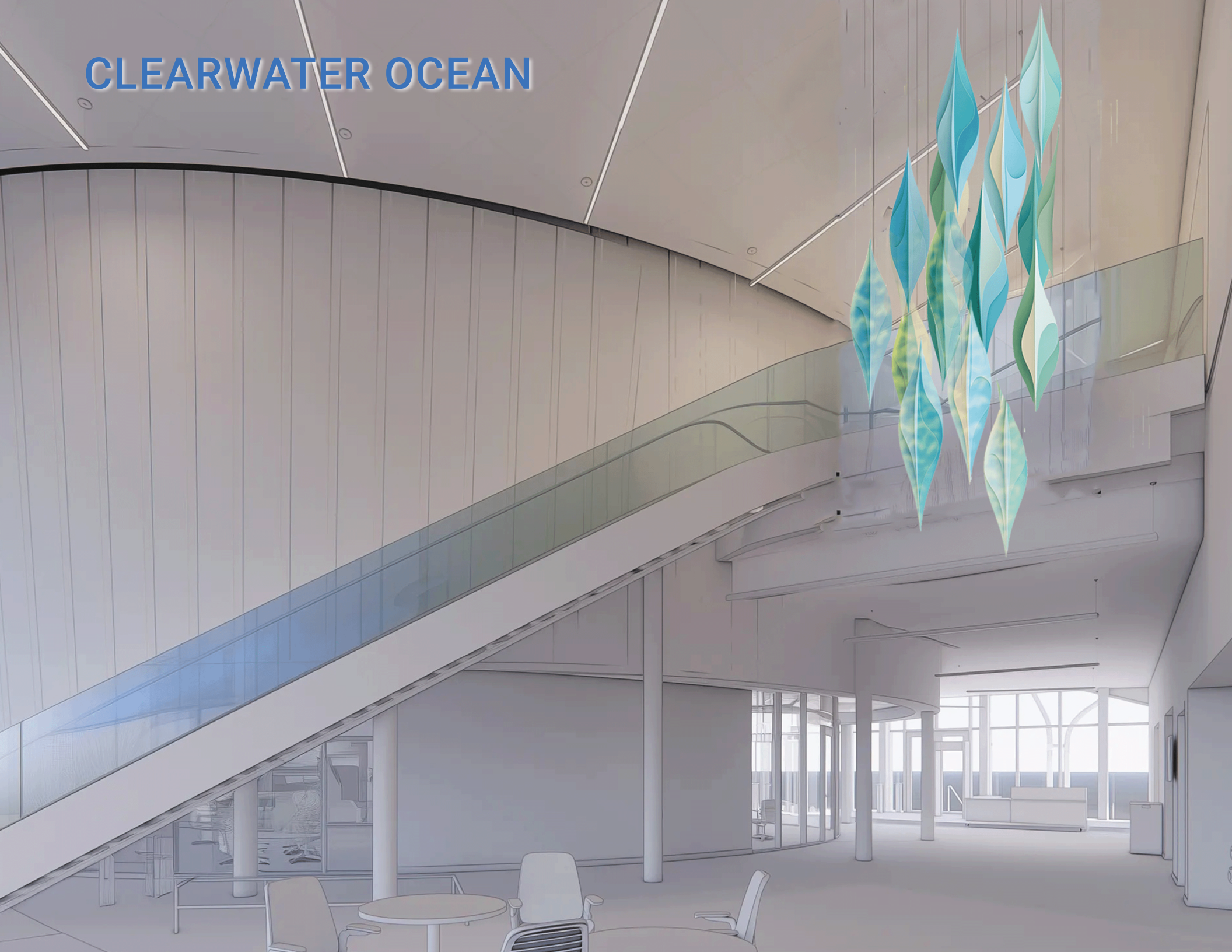



CONCEPT

Inspired by witnessing a dolphin super pod, I envision a lightweight sculpture in Clearwater's new City Hall atrium -- an ocean current of light. Its abstract form suggests the graceful migration of marine life through water. Crafted from multicolored gradient plexiglass and marine-grade aluminum, the work reflects Clearwater's signature blues, greens, and sandy tones, embodying the city's motto:

Bright and Beautiful – Bay to Beach.

"OCEAN" Detail



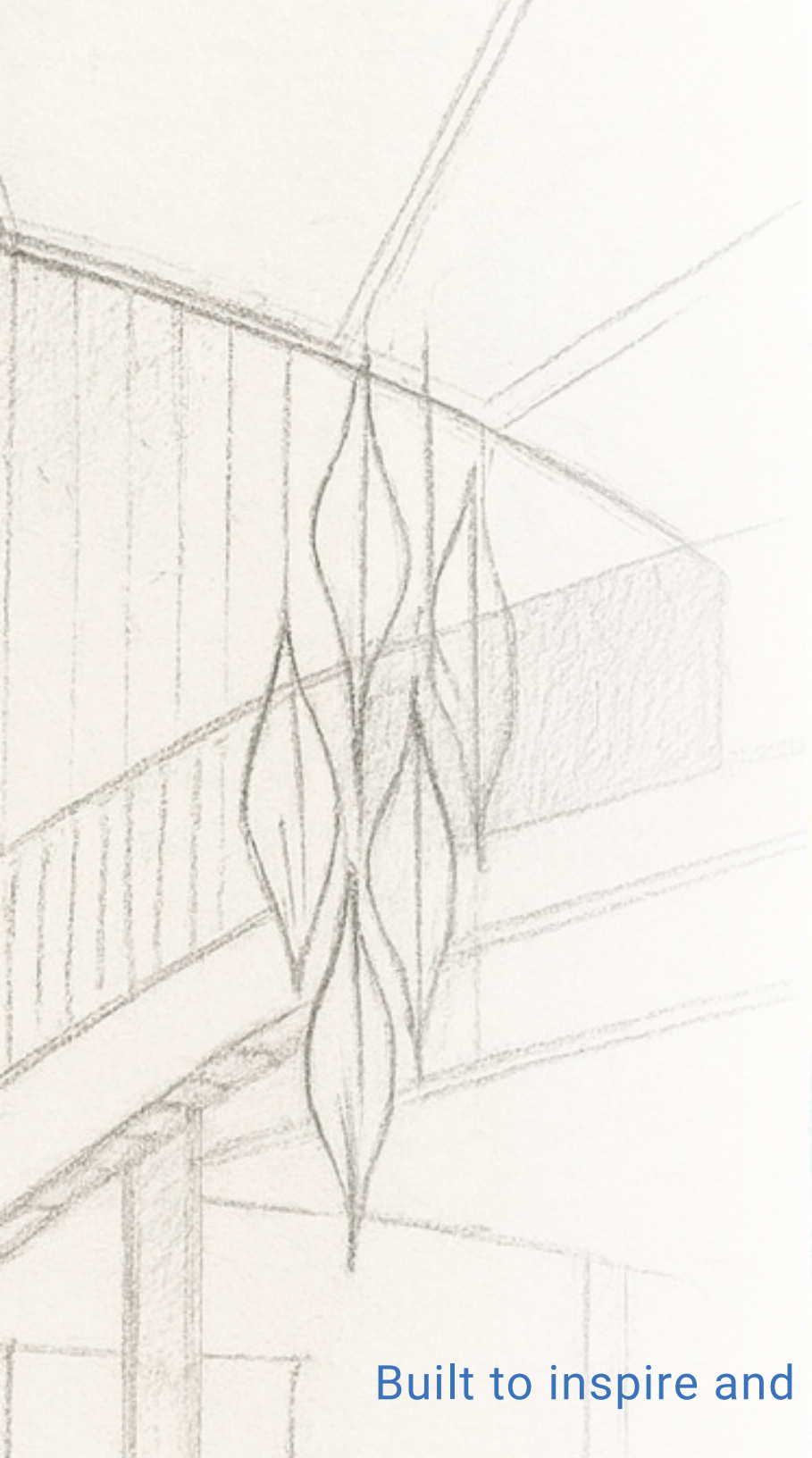

Physical:

- Height: ~14 ft | Diameter: ~4 ft
- Weight: 900–1,250 lbs •

Materials: Plexiglass Gradient Panels, marine-grade aluminum frame, stainless steel suspension hardware • **Engineered** anchoring into City Hall's structural steel • Designed for generations of durability in Florida's coastal climate.

Illumination

- Daylight: Sunlight refracts into shifting colors across atrium walls and floors, echoing Clearwater's waters.
- Evening: Existing architectural lighting keeps the sculpture glowing warmly.

Mounting Hardware

- Suspension system of stainless steel cables and brackets
 - Redundant safety cables and tamper-proof fasteners •
- Concealed anchoring ensures a clean, floating appearance.

Maintenance & Durability

- UV-stable gradient Plexiglass resists fading
 - anodized aluminum prevents corrosion
 - Minimal upkeep: annual inspection
- + light dusting/cleaning.

Built to inspire and be a civic beacon for decades





Art Concept 2: CLEARWATER SKY

DAVIS

CLEARWATER SKY

MAX SCULPTURE WIDTH
DIA. 6'-0"



MAX SCULPTURE HEIGHT
17'-6"

HEIGHT ABOVE FIRST FLOOR
10'-0"

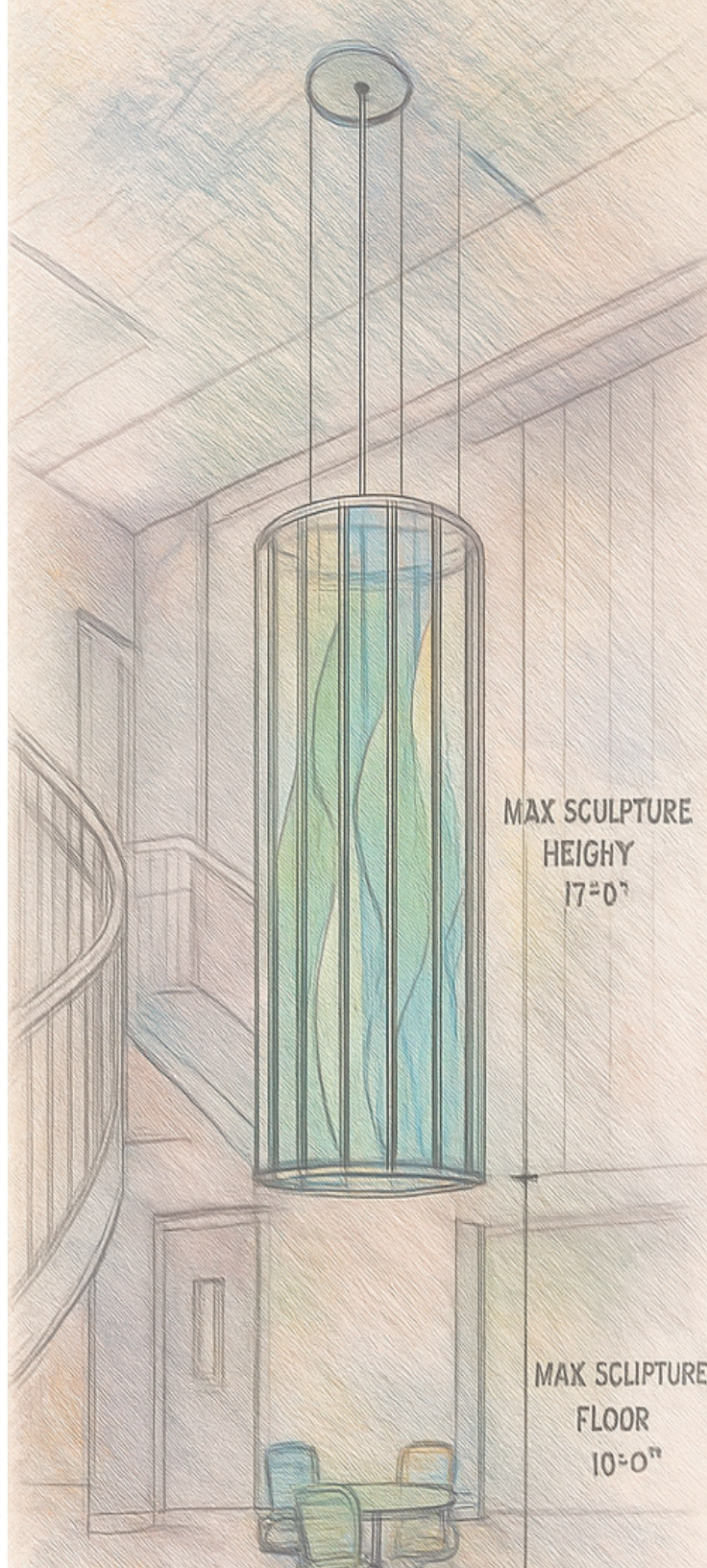
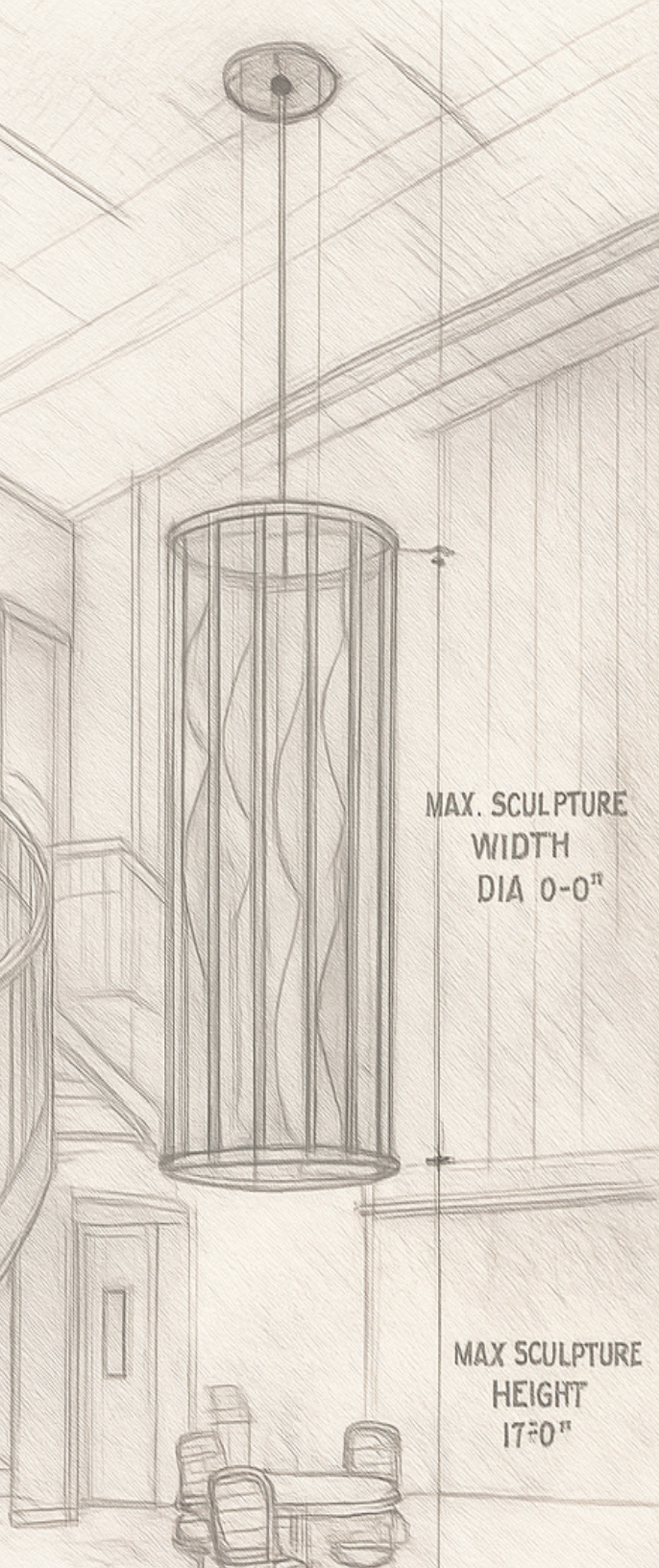

CLEARWATER SKY

Physical:

- Height: ~16 ft | Diameter: ~6 ft
- Weight: 1,250–1,500 lbs •

Materials: Plexiglass Gradient Panels, marine-grade aluminum frame, stainless steel suspension hardware •

Engineered anchoring into City Hall's structural steel

Illumination

- Daylight: Sunlight refracts into shifting colors across atrium walls and floors, echoing Clearwater's waters. • Evening: Existing architectural lighting keeps the sculpture glowing warmly.

Mounting Hardware

- Suspension system of stainless steel cables and brackets
 - Redundant safety cables and tamper-proof fasteners •
- Concealed anchoring ensures a clean, floating appearance.

Maintenance & Durability

- UV-stable gradient Plexiglass resists fading
- anodized aluminum prevents corrosion
- Minimal upkeep: annual inspection + light dusting/cleaning •

Handcrafted in the USA

COLOR STUDY: Sky

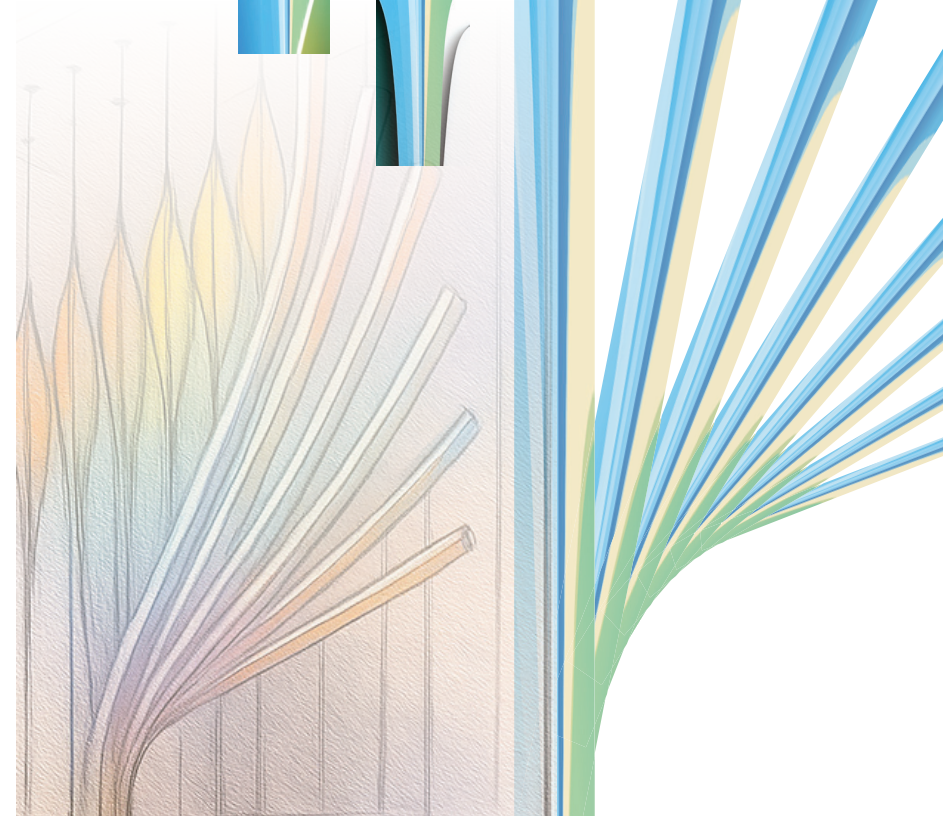

MY PROCESS

I begin all sculptures with a site visit. This is critical to understanding the angle and interaction of sunlight in the area. 360° photos are taken to best recreate that environment in a digital space. A scale maquette, often with variations, is created in the studio for the artist to best understand the sunlight shadow patterns that will be created.

Once the final design is confirmed, plans are submitted to a structural engineer to generate a stamped drawing. This information will finalize the size dimensions of the underground concrete base and dictate the correct mechanical attachment methodology. Typically the artist (me) will travel to the site and oversee the installation of this base 14-30 days before the sculpture is scheduled to arrive on site.

The sculpture will be crated and packed for transport in modules. At this stage it consists of a welded frame that bolts together to form the full structure and a series of unique prisms that will be affixed to the frame with stainless steel screws. Upon arrival the sculpture will be fitted to the existing base and assembled with ladders. The build team typically works a 10-12 hour day. The artist tries to Tom Sawyer them into working longer but it's futile. Each column can be assembled in one day, or less, in a best case scenario. The total time to complete assembly and leave a clean worksite behind is approximately 5 working days. The team is happy to accommodate working off hours so as not to interfere with any city operations. After the install the protective film is removed from the plexiglass. A photographer or videographer is hired to document the work.

Training is provided, and can be scheduled remotely.

An after care kit & manual is left for the ongoing maintenance of the sculpture.

Installation Timeline:

After city approval, signed contract, & deposit.

Week 1:

Provide 2d layout diagram for anchoring of each column.
Provide 2d layout for electrical power requirements & lighting layouts.
Begin fabrication of dichroic sheets.
Begin fabrication (sanding and cutting) of aluminum frame.

Week 2:

Continue fabrication of dichroic sheets.
Continue fabrication of aluminum frame.

Week 3:

Laser cut 1:1 scale of prisms in cardboard.
Begin Welding of aluminum frame.

Week 4:

Begin laser cutting dichroic prisms.
Complete welding of aluminum frame.

Week 5:

Continue laser cutting and assembling dichroic prisms
Test fit & full build of Aluminum Frame
Travel to Site for concrete base installation

Week 6 -8:

Buffer for fabrication.
Begin crating sculpture.
-> Next Travel to site
Install finished sculpture &
Professionally Document work

MY INSTALL PROCESS

STAINLESS STEEL FRAME ATTACHMENT DIAGRAM

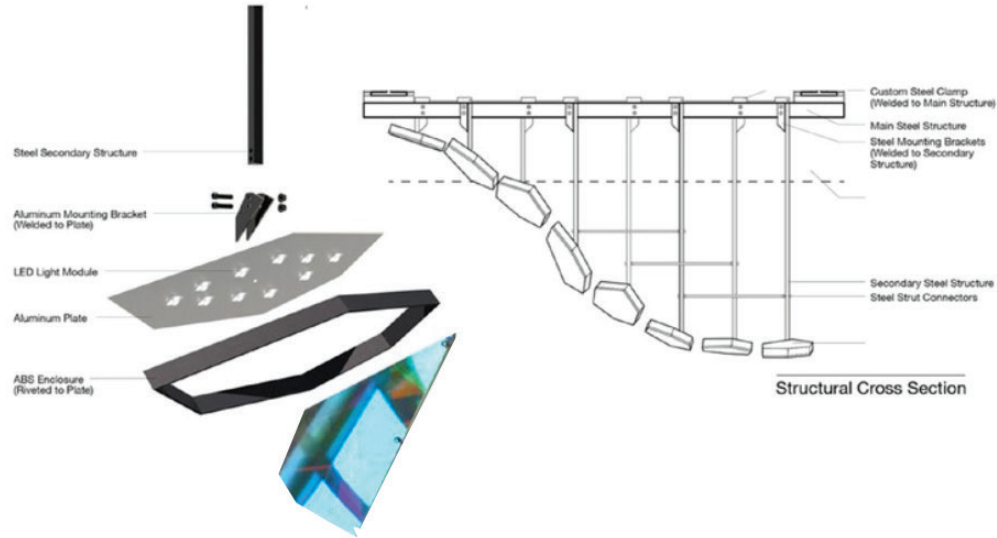

TELESCOPIC BOOM LIFT REQUIRED



INSTALLED WITH GRIPLOCK® LIGHTING SEISMIC BRACING SYSTEM

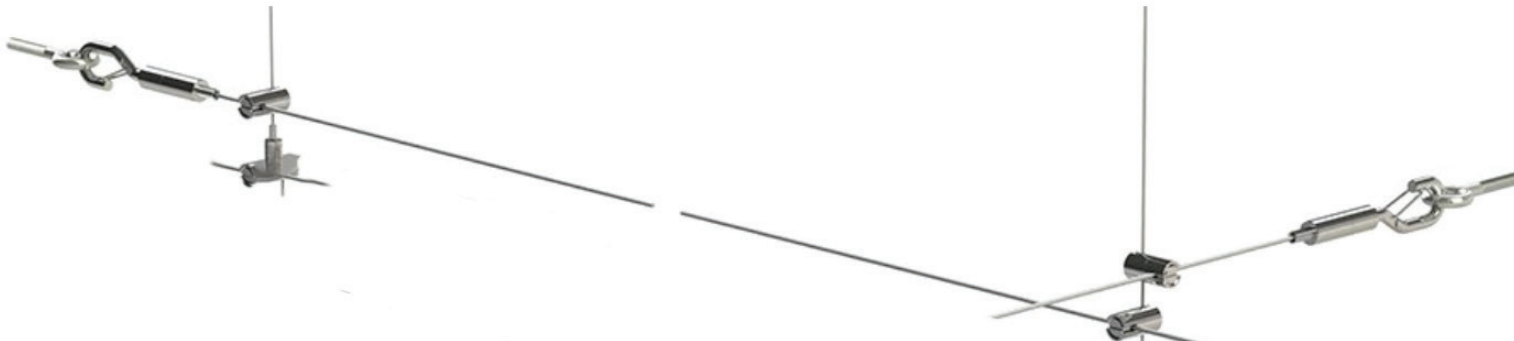

TIMELINE

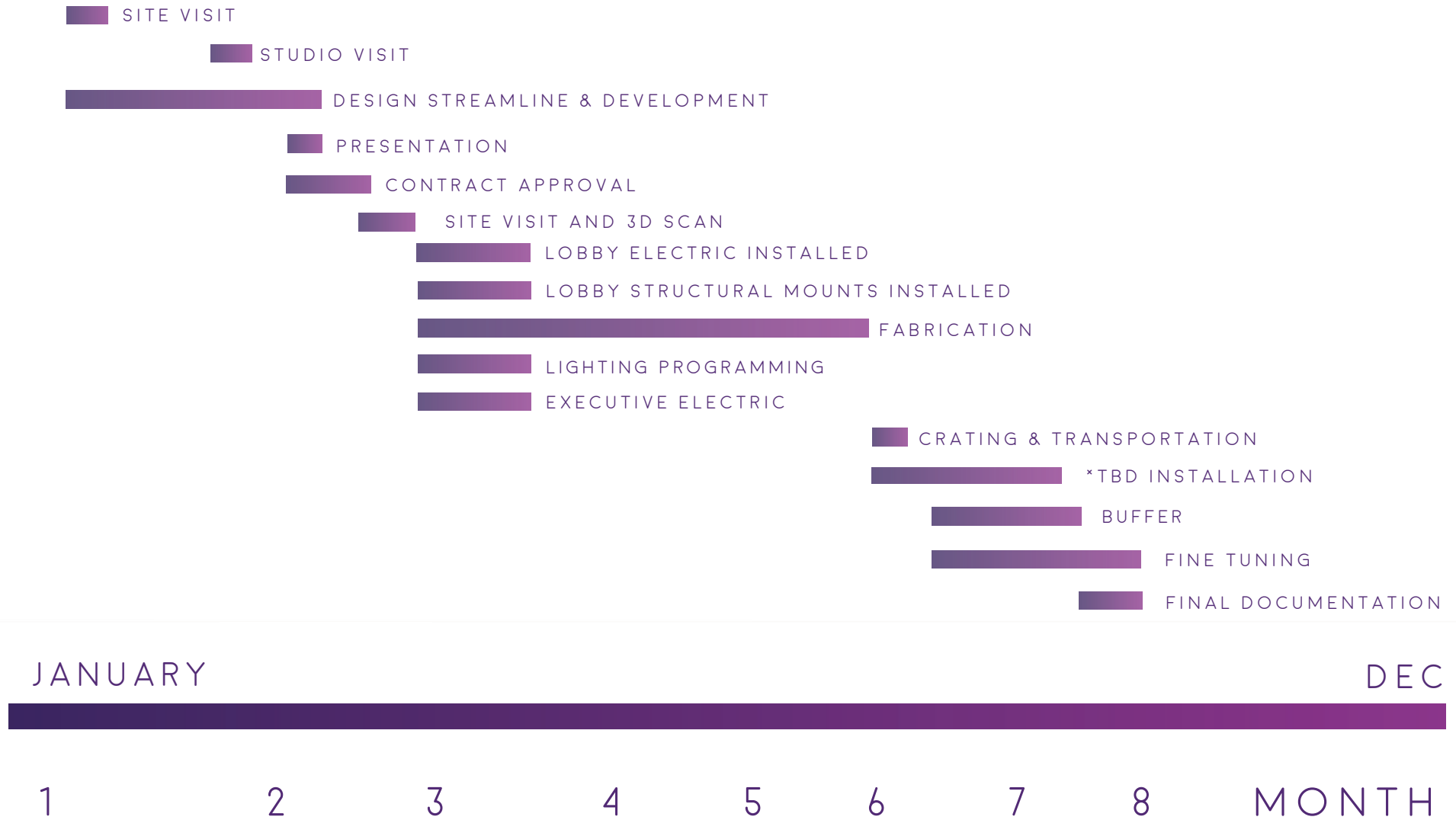



TOGETHER WE CAN
CHANGE THE FUTURE

Davis McCarty

www.DavisMcCarty.com

dm@davismccarty.com

@DicroDavis

DICRO
DAVIS 